

ELEVATOR BOLTS

Stainless, Carbon
and Zinc-Plated
Steel

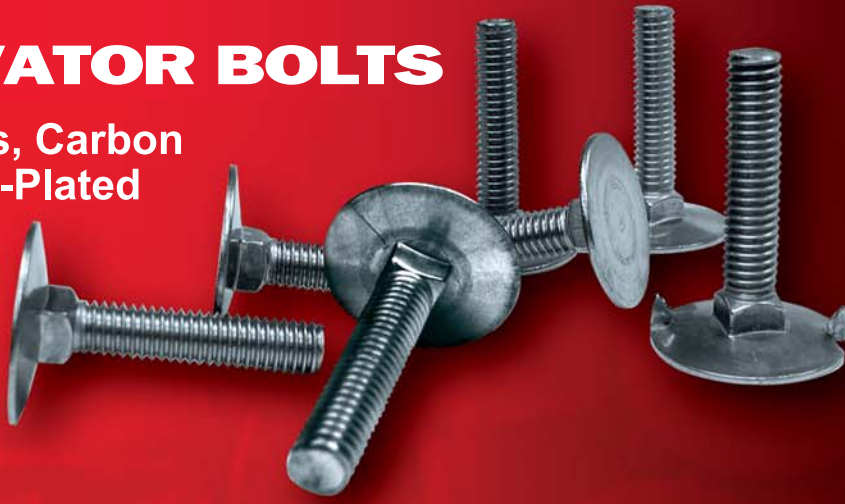

UHMW DRAG CONVEYOR FLIGHTS

Standard and
Custom Designs



MAXI-SPLICE BELT FASTENING SYSTEM



SCREW CONVEYOR HANGER BEARINGS



Maxi-Lift Inc.

PARTS AND ACCESSORIES

Elevator Bolts

Same Day Shipping Available

Maxi-Lift exceeds all industry standards for grade 2 elevator bolts.

STANDARD ELEVATOR BOLT

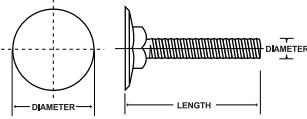

Standard #1 Norway

- Carbon Steel
- Stainless Steel
- Zinc Plated



SABRE-TOOTH™ ELEVATOR BOLT

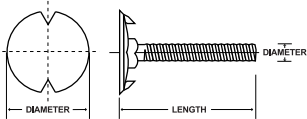

Sabre-Tooth®

- Carbon Steel
- Stainless Steel
- Zinc Plated

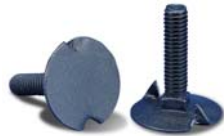

RELIANCE ELEVATOR BOLT

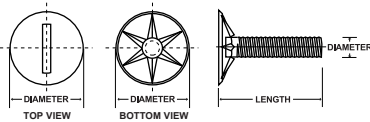

#3 Slotted Head

- Carbon Steel
- Zinc Plated



HEX HEAD BOLT

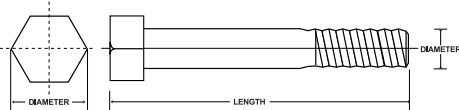

Hex-Head®

- Zinc Plated
- Grade 5
- Used with Chain Attachments



Maxi-Lift continually applies metallography tests to our fasteners to ensure the finest quality parts are upheld. ASTM certificates are on file and available upon request.

STANDARD ELEVATOR BOLT			
Size, Inches	Weight /100 pcs., lbs.	Case Qty	Keg Bulk Qty
1/4 x 3/4	2.94	1200	2000
* 1/4 x 1	3.24	1200	1700
* 1/4 x 1-1/4	3.43	1200	1500
* 1/4 x 1-1/2	3.73	1200	1300
1/4 x 1-3/4	3.98	1200	1200
1/4 x 2	4.29	1200	1000
1/4 x 2-1/4	4.88	600	900
1/4 x 2-1/2	4.92	600	800
5/16 x 3/4	4.76	1200	1200
* 5/16 x 1	5.05	1200	1000
* 5/16 x 1-1/4	5.55	1200	900
* 5/16 x 1-1/2	6.38	600	800
5/16 x 1-3/4	6.50	600	700
* 5/16 x 2	7.12	600	600
5/16 x 2-1/4	7.43	600	550
5/16 x 2-1/2	7.78	600	500
3/8 x 1-1/4	6.54	600	750
3/8 x 1-1/2	7.10	600	700
3/8 x 1-3/4	7.66	600	600
* 3/8 x 2	8.31	600	500
3/8 x 2-1/4	9.35	600	450
3/8 x 2-1/2	9.83	600	400
3/8 x 3	10.79	600	300

SABRE-TOOTH ELEVATOR BOLT			
Size, Inches	Weight /100 pcs., lbs.	Case Qty	Keg Bulk Qty
1/4 x 3/4	2.94	1200	2000
* 1/4 x 1	3.24	1200	1700
* 1/4 x 1-1/4	3.43	1200	1500
* 1/4 x 1-1/2	3.73	1200	1300
1/4 x 1-3/4	3.98	1200	1200
* 1/4 x 2	4.29	1200	1000
1/4 x 2-1/4	4.88	600	900
1/4 x 2-1/2	4.92	600	800
5/16 x 3/4	4.76	1200	1200
* 5/16 x 1	5.05	1200	1000
* 5/16 x 1-1/4	5.55	1200	900
* 5/16 x 1-1/2	6.38	600	800
* 5/16 x 1-3/4	6.50	600	700
* 5/16 x 2	7.12	600	600
5/16 x 2-1/4	7.43	600	550
5/16 x 2-1/2	7.78	600	500
3/8 x 1-1/4	6.54	600	750
3/8 x 1-1/2	7.10	600	700
3/8 x 1-3/4	7.66	600	600
* 3/8 x 2	8.31	600	500
3/8 x 2-1/4	9.35	600	450
3/8 x 2-1/2	9.83	600	400
3/8 x 3	10.79	600	300

RELIANCE ELEVATOR BOLT			
Size, Inches	Weight /100 pcs., lbs.	Case Qty	Keg Bulk Qty
1/4 x 3/4	2.7	1200	2400
1/4 x 1-1/4	3.0	1200	1800
1/4 x 1-1/2	3.5	1200	1800
5/16 x 1-1/4	4.9	1200	1200

HEX HEAD BOLTS			
Size, Inches	Weight /100 pcs., lbs.	Case Qty	Keg Bulk Qty
1/2 X 1	8.50	1200	1700
1/2 x 1-1/4	9.45	1200	1500
1/2 x 1-1/2	10.70	1200	1300
3/8 x 1	4.15	1200	1700
3/8 x 1-1/4	4.80	1200	1500
3/8 x 1-1/2	5.65	1200	1300

* Available in Stainless Steel

Call: 1-800-527-0657 or Visit Us Online at: www.maxilift.com

16400 Midway Rd Dallas, TX 75001 • Ph: (972)735-8855 Fx: (972)735-8896 • info@maxilift.com

Washers, Nuts and Spacers

Same Day Shipping Available

ACCESSORY PACK

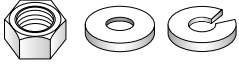
HEX NUT, FLAT & LOCK WASHER			
	SIZE, INCHES (ID)	PKG. QTY., PCS.	PKG. WEIGHT, LBS.
	1/4	100	2.2
	5/16	100	3.5
	3/8	100	5.2
	1/2	100	8.9

Available in zinc and stainless.

NUTS

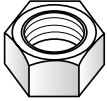
STANDARD HEX			
	SIZE, INCHES (ID)	PKG. QTY., PCS.	PKG. WEIGHT, LBS.
	1/4-20	100	.7
	5/16-18	100	1.1
	3/8-16	100	1.6
	1/2	100	3.8

Available in zinc and stainless.

STANDARD FLANGE SERRATED LOCK			
	SIZE, INCHES (ID)	PKG. QTY., PCS.	PKG. WEIGHT, LBS.
	1/4-20	100	.9
	5/16-18	100	1.2
	3/8-16	100	1.8

Available in zinc and stainless.

LARGE FLANGE SERRATED LOCK			
	SIZE, INCHES (ID)	PKG. QTY., PCS.	PKG. WEIGHT, LBS.
	1/4-20	100	1.2
	5/16-18	100	2.3
	3/8-16	100	2.8

Available in zinc.

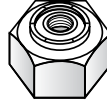
NYLON INSERT LOCK			
	SIZE, INCHES (ID)	PKG. QTY., PCS.	PKG. WEIGHT, LBS.
	1/4-20	100	.8
	5/16-18	100	1.1
	3/8-16	100	2.8

Available in zinc and stainless.

Directions for Proper Elevator Bolt Torque on Belt

1. To tighten the nuts, use a torque wrench that will "click" out when proper setting is reached.
2. Run the elevator with the buckets empty for 4 hours.
3. Check all bolts to insure that the proper torque is maintained.

RECOMMENDED TORQUE FOR ELEVATOR BOLTS

SHANK DIAMETER	STEEL			STAINLESS		
	in. / lbs.	kgm / m.	ft. / lbs.	in. / lbs.	kgm / m.	ft. / lbs.
1/4"	50	.57	4	86	.99	7.16
5/16"	96	1.10	8	177	2.04	14.75
3/8"	180	2.07	15	-	-	-

**Do not exceed recommended torque values, as this could strip the bolts.

Recommended Bucket Installation

*A locking device should be used on all elevator bucket installations.

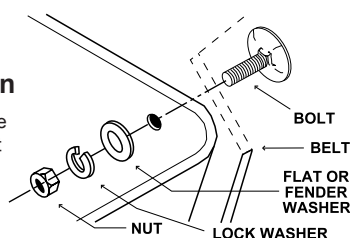

WASHERS AND SPACERS

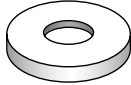
FLAT			
	SIZE, INCHES (ID)	PKG. QTY., PCS.	PKG. WEIGHT, LBS.
	1/4	100	1.3
	5/16	100	2.0
	3/8	100	3.0
	1/2	100	3.8

Available in zinc and stainless.

SPLIT RING LOCK			
	SIZE, INCHES (ID)	PKG. QTY., PCS.	PKG. WEIGHT, LBS.
	1/4	100	.2
	5/16	100	.4
	3/8	100	.6
	1/2	100	1.4

Available in zinc and stainless.

EXTERNAL TOOTH LOCK			
	SIZE, INCHES (ID)	PKG. QTY., PCS.	PKG. WEIGHT, LBS.
	1/4	100	.7
	5/16	100	.7
	3/8	100	.7

Available in zinc and stainless.

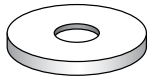
FENDER			
	SIZE, INCHES (ID)	PKG. QTY., PCS.	PKG. WEIGHT, LBS.
	1/4	100	1.3
	5/16	100	2.0
	3/8	100	3.0

Available in zinc and stainless. * Available in Large O.D.

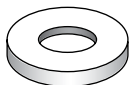
LEATHER			
	SIZE, INCHES (ID)	PKG. QTY., PCS.	PKG. WEIGHT, LBS.
	1/4	100	.3
	5/16	100	.3
	3/8	100	.3

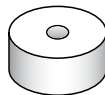
POLY SPACERS			
	SIZE, INCHES (ID)	PKG. QTY., PCS.	PKG. WEIGHT, LBS.
	1/4	100	2.0
	5/16	100	1.8
	3/8	100	2.0

Available in 1/4" and 1/2" thick.

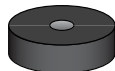
NEOPRENE			
	SIZE, INCHES (ID)	PKG. QTY., PCS.	PKG. WEIGHT, LBS.
	1/4	100	1.1
	5/16	100	1.1
	3/8	100	1.1

Available in 1/4" thick.

Call: 1-800-527-0657 or Visit Us Online at: www.maxlift.com

16400 Midway Rd Dallas, TX 75001 • Ph: (972)735-8855 Fx: (972)735-8896 • info@maxlift.com

PARTS & ACCESSORIES: BOLTS & ACCESSORIES



Elevator Bolts & Accessories

Bolt Stocking Program Information



Shelf Packs

Cases

Standard Packaging:

Standard packaged elevator bolts are available in both Case and Keg quantities. Kegs are bulked packed without hex nuts. Case quantities are shelf packed per hundred or fifty pieces and include hex nuts. Shelf packs are packed into case quantities of 1200 or 600 depending on size. Cases are available without hex nuts on request.

Shipping Guarantees:

Same Day Shipments:

All in stock standard packaged elevator bolt orders that are received by 1:00 PM CST will be shipped the same day the order is received.

Great Savings For Stocking Distributors!



Kegs

Custom Bolt Programs:

Special Packaging:

Special packaging for elevator bolts is available upon request. Please call for special requirements. Additional value added costs may be incurred.

Special Labeling:

Special labeling for elevator bolts is available upon request. Please call for special requirements. Additional value added costs may be incurred.

Special Elevator Bolt Sizes:

Please call with your inquiry for elevator bolts which are not listed in this catalog. Other sizes, styles and materials are available upon request.

Testing Procedures

Maxi-Lift exceeds all industry standards for grade 2 elevator bolts. Maxi-Lift continually applies metallography tests to our fasteners to ensure the finest quality parts are upheld. ASTM certificates are on file and available upon request.

Call: 1-800-527-0657 or Visit Us Online at: www.maxilift.com

16400 Midway Rd Dallas, TX 75001 • Ph: (972)735-8855 Fx: (972)735-8896 • info@maxilift.com

Maxi-Splice Belt Fastening Device

Same Day Shipping Available

Template Tape and Power Punch

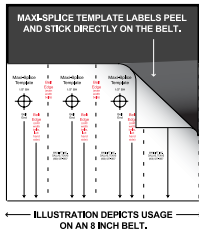

TEMPLATE TAPE - FREE

- Peel and stick directly on belt
- Improves belt-punching convenience
- Marks hole locations for odd or even width belts
- Clearly marked in white and red lettering
- Included with every splice order



POWER PUNCH

- Made with durable heat treated carbon-steel
- Reinforced blade easily cuts 1/2" diameter holes
- Impact adapter available when necessary
- Use with a hand-held mallet, impact wrench, or drill
- Always wear eye protection

Splices

MAXI-SPLICE AB

- Non-ferrous metal of very high tensile strength
- Usable on belts of up to 1200 PIW tensile
- Non-sparking, non-corroding and non-rusting
- Bronze color
- Weight: 2.9 lbs. each



MAXI-SPLICE CI

- Ferrous metal of moderately high tensile strength
- Usable on belts of up to 600 PIW tensile
- Silver color
- Weight: 2.6 lbs. each



DESCRIPTION

- The Maxi-Splice is a mechanical clamping device with a simple three-piece construction. The patented design is for use on PVC and rubber belting.
- Use 4" long bolts for belts up to 1/4" thick.
- Use 4 1/2" long bolts for belts between 1/4" and 1/2" thick.
- Use 5" long bolts for belts between 1/2" and 3/4" thick.
- Maximum operating temperatures: **AB: 500°F, CI: 600°F.**
- Each splice set accommodates two inches of belt width.
- It is tested and approved by leading manufacturers of PVC and rubber belting.

**Patent No. 4,540,389*

INSTALLATION

1. First ensure the belt ends are square and even. If using the splice template tape, apply the tape to mark the punching. Be sure to apply the tape squarely on the belt ends; then proceed to Step 4. If you are not using the tape, go to Step 2.
2. Draw a line approximately 4-1/4" from the belt end to use as the center line for hole punching. Proper installation for even width belts will begin just inside the belt edge. Odd belt widths require installation 1/2" from the belt edge.
3. Use the Maxi-Splice as a template to mark the hole locations for punching. After marking the first hole, move over 2" and mark each consecutive hole.
4. Punch both belt ends for 1/2" diameter bolts.
5. The two end plates and center plate are used for firm belt gripping. The end plates have two gripping areas – the slotted gripping area is mounted toward the face of the belt and is followed by a series of gripping teeth. These teeth are always mounted toward the tail of the belt. The center plate is symmetrical and cannot be improperly installed.
6. **IMPORTANT:** We have supplied a 1/2" diameter, 4" long Grade 5 bolt and nylon locking nut. The bolts must be torqued for Maxi-Splice to effectively clamp. The torque requirement is 75 foot pounds for belts up to and including 600 PIW – belts greater than 600 PIW tensile require 100 foot pounds of torque.
7. Run the belt for thirty minutes; stop the leg and re-torque the bolts.
8. When reinstalling the Maxi-Splice always use new Nylock nuts.

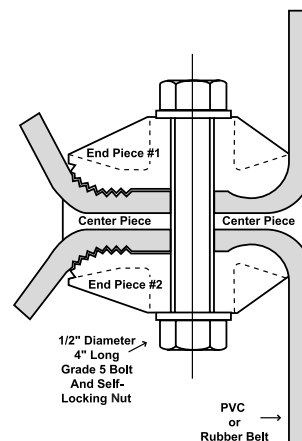

WARNING: Do Not Use Maxi-Splice on Manlifts!

- Maxi-Lift, Inc. and Dura-Buket, Co neither solicits nor recommends the use of the Maxi-Splice CI or AB belt clamp in splicing man lift belts. The Maxi-Splice was not designed for or tested for this purpose. Any installation of the Maxi-Splice in this application may cause serious harm or even death. Do not use on steel cable belts.
- Do not re-use nylock nuts on Maxi-Splices. When reinstalling splices, please use new nylock nuts. Replacements are available from Maxi-Lift.
- The AB and CI Maxi-Splice is not recommended for use on a standard wing pulley. It may cause premature wear of the backside of the belt around the splice. It may also create noise in the boot section of the bucket elevator as the metal splice may contact the wings of the pulley. The AB and CI Maxi-Splice may be used on a spiral wing pulley.

Call: 1-800-527-0657 or Visit Us Online at: www.maxilift.com

16400 Midway Rd Dallas, TX 75001 • Ph: (972)735-8855 Fx: (972)735-8896 • info@maxilift.com



PARTS & ACCESSORIES: MAXI-SPLICE

Screw Conveyor Hanger Bearings

OTHER SIZES AVAILABLE ON REQUEST.

DIMENSIONS				
A	B	C	D	E
1-1/2	2-3/16	2-1/2	1-7/8	1-9/16
2	2-3/4	3-1/8	1-15/16	1-9/16
2-7/16	3-1/4	3-11/16	2-15/16	2-3/8
3	4	4-3/8	2-15/16	2-1/4
3-7/16	4-3/4	5	3-3/16	3-1/16

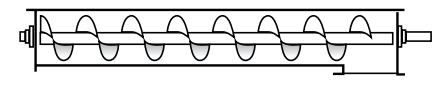
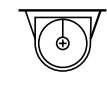
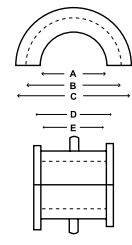





SCREW CONVEYOR

STYLE "A" BEARING: STYLE 226

Two-piece double flange bearing for screw conveyor hanger with formed strap. This hanger bearing is interchangeable with the following styles: 20A, 20B, 26B, 28A, 30, 50, 220, 226 228 and 326.

***HANGER STRAP NOT INCLUDED**

MAXI-LIFT HANGER BEARINGS	PLASTECH	WEARITE*	UHMW	WOOD
				
MATERIAL	Engineered nylon resin	Engineered nylon resin	Polyethylene	Maple
GRADE	Food grade, FDA	Industrial grade	Food grade, FDA	Industrial grade
METHOD OF MANUFACTURE	Injection molded	Injection molded	Machined or molded	Machined
TEMPERATURE OPERATING RANGE	-60°F to +300°F	-60°F to +300°F	-22°F to +180°F	-50°F to +160°F
LUBRICANT	Built-in lubricant	Built-in lubricant*	Natural	Oil impregnated
COLOR	Tan	Black	White	Brown

*Wearite bearings available drilled and tapped for lubing or purging pipes at additional cost.

STYLE "B" BEARING: STYLE 18B

Cap type half bearing for screw conveyor hanger with U-bolt construction. Hanger Styles 17, 18, 18A, 18B, 19B and 40. Available in wood and UHMW.

***HANGER STRAP NOT INCLUDED**

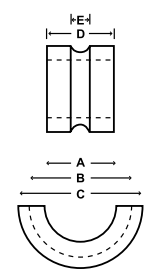

DIMENSIONS				
A	B	C	D	E
3	3-7/8	4-13/16	2-7/8	13/16
3-7/16	4-7/16	5-3/8	3-13/16	7/8

STYLE "C" BEARING: STYLE 216

Two piece bearing with rectangular upper half and double flange lower half for Hanger Styles 16, 16B, 16C, 24, 24A, 24B, 28, 216, 216B, 216C, 216F, 230 and 316. Available in wood and UHMW. Call for sizes and dimensions.

***HANGER STRAP NOT INCLUDED**

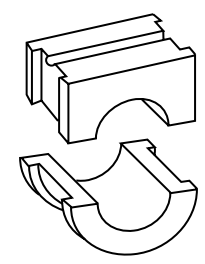

Call: 1-800-527-0657 or Visit Us Online at: www.maxilift.com

16400 Midway Rd Dallas, TX 75001 • Ph: (972)735-8855 Fx: (972)735-8896 • info@maxilift.com

UHMW Sheet Material Specifications

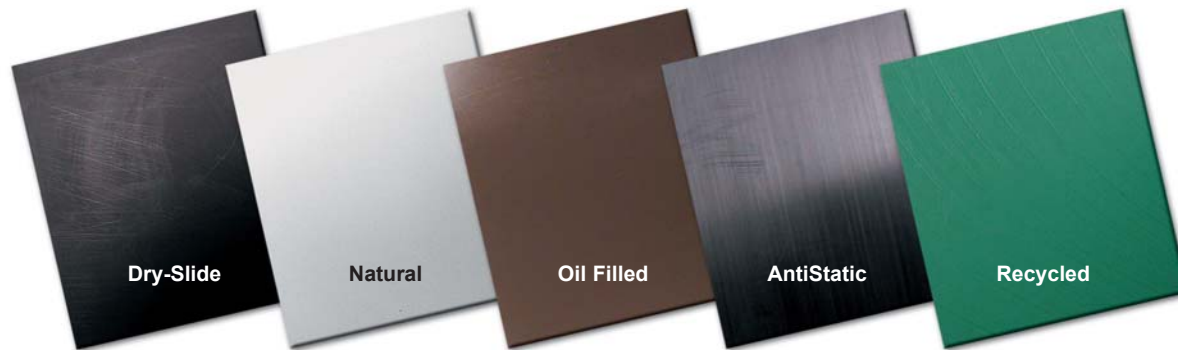

Natural UHMW – White in color. This UHMW sheet meets FDA/USDA and 3-A dairy guidelines. It is an excellent high wear material.

Reprocessed or Recycled UHMW – Green or Black in color. This sheet is a blend of virgin and regenerated UHMW polymers that maintain an acceptable combination of properties for less demanding applications. This sheet is not FDA approved.

AntiStatic UHMW – Black in color. This UHMW sheet protects parts sensitive to build up of static electricity. It permits partial transmission of electrical charge, thus dissipating static build-up. It provides a slick surface.

Dry-Slide UHMW – Black in color. This UHMW sheet is modified with special dry additives for enhanced coefficient of friction and antistatic properties. This is an effective sheet in dusty environments where components need lubrication without build-up.

Oil Filled UHMW – Brown in color. This UHMW sheet meets FDA/USDA guidelines for food and pharmaceutical handling. It has an oil additive to lubricate mating surfaces. This Oil Filled UHMW is used in closed loop continuous chain applications. It is not recommended for dusty applications.

PRIME UHMW POLYETHYLENE SHEETING (PER SHEET) 48" X 120"		
GAUGE, INCHES	WEIGHT, LBS./SHEET	TOLERANCE
1/16"	13	+/- 10%
1/8"	25	+/- 10%
3/16"	38	+/- 10%
1/4"	50	+/- 10%
3/8"	75	+/- 10%
1/2"	100	+/- 10%
5/8"	125	+/- 10%
3/4"	150	+/- 10%
1"	200	+/- 10%
1-1/4"	250	+/- 10%
1-1/2"	300	+/- 10%
1-3/4"	350	+/- 10%
2"	400	+/- 10%
2-1/2"	500	+/- 10%
3"	600	+/- 10%
3-1/2"	700	+/- 10%
4"	800	+/- 10%

Temperature Range: Continuous -22° F to +180° F

Call: 1-800-527-0657 or Visit Us Online at: www.maxilift.com

16400 Midway Rd Dallas, TX 75001 • Ph: (972)735-8855 Fx: (972)735-8896 • info@maxilift.com

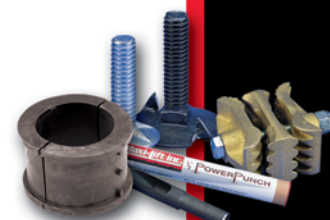







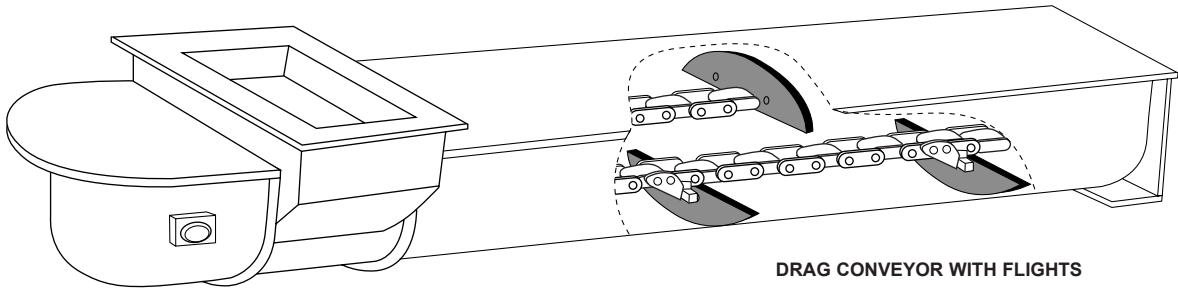

Drag Conveyor Flights

Common Sizes and Styles In Stock for Immediate Delivery



DRAG CONVEYOR WITH FLIGHTS

DRAG CONVEYOR FLIGHTS						
FLIGHTS:						
SIZE, INCHES (LENGTH AND THICKNESS)	SCREW CONVEYOR SUPERFLO	ESSMUELLER COMPANY PEERLESS	THOMAS CONVEYOR FLI-CON	JEFFERY MULTI-FLOW	EHRSAM DRACÓN	ENMASSE
6 X 1/4	X	-	-	X	-	X
6 X 1/8	X	-	X	-	X	X
9 X 1/4	X	-	-	X	-	X
9 X 3/8	X	X	-	X	X	X
9 X 1/2	X	X	X	-	-	X
10 X 3/8	-	-	-	-	-	X
10 X 1/2	-	-	-	-	-	X
12 X 3/8	X	X	-	X	X	X
12 X 1/2	X	X	X	-	-	X
14 X 3/8	X	X	-	X	X	X
14 X 1/2	X	X	-	-	-	X
16 X 3/8	X	X	-	X	-	X
16 X 1/2	X	X	X	-	-	X
18 X 3/8	X	-	-	X	-	X
18 X 1/2	X	X	-	-	-	X
20 X 1/2	-	X	-	X	-	X
20 X 5/8	-	-	X	-	-	X
24 X 1/2	-	X	-	X	-	X
24 X 5/8	-	-	X	-	-	X

* Photos of drag conveyor flights are representations of flights. Actual flights may vary in size and shape.

Specifications:

- Material:** Virgin Ultra High Molecular Weight (UHMW) polyethylene is white. Reprocessed UHMW polyethylene is green or black. Static reduced UHMW is black. UHMW has a thickness tolerance of +/- 10%.
- Style:** Drag conveyor flights are fabricated to original manufacturer's design. Cut edges are square unless otherwise noted.
- Custom Flights:** Non-standard flights can be custom fabricated to your specifications. Please send print or sample for fabrication of flight.
- Temperature:** -22° F to +180° F or -51° C to +82° C
- Ordering:** Before ordering, please note manufacturer design, number of flights, size and thickness. If a custom drag conveyor flight is required, please have sample or drawing available.

Call: 1-800-527-0657 or Visit Us Online at: www.maxilift.com

16400 Midway Rd Dallas, TX 75001 • Ph: (972)735-8855 Fx: (972)735-8896 • info@maxilift.com

Custom Drag Flights

Complete and Fax for a Custom Quote

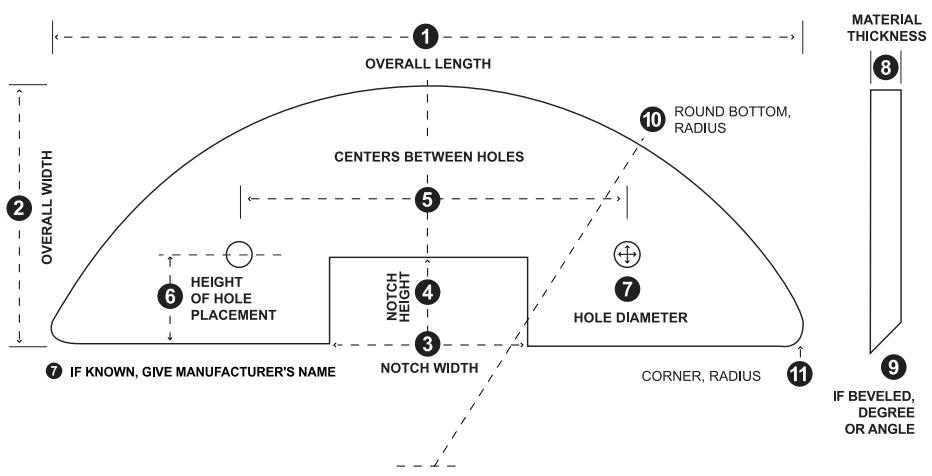

Round Bottom Flights

Round bottom flights are standardized according to conveyor manufacturer. Most common sizes and styles are stocked for immediate shipment. Custom round bottom flights can be made and shipped quickly.

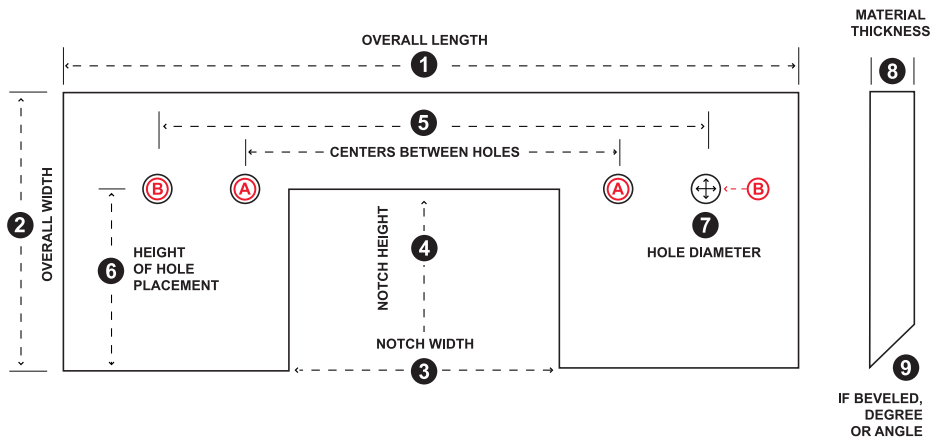

En Masse Flights

The en masse flight is the most customized flight design. It can vary in height, length and thickness. There are few standardized en masse sizes.

Please fill in the following information and fax back to Maxi-Lift at (972)735-8896.

USER INFORMATION (Primary Contact)

Name: _____

Title: _____

Company Name: _____

Shipping Address: _____

City: _____

State: _____ Zip: _____

Phone: _____

Fax: _____

Email Address: _____

Website: _____

DRAG FLIGHT SPECIFICATIONS

Please Check One:
 ROUND BOTTOM: _____ EN MASSE _____

1 Overall Length: _____

2 Overall Width: _____

3 Notch Width: _____

4 Notch Height: _____

5 Centers Between the Holes:
 Round Bottom: _____
 En Masse (A) _____ (B) _____
 (A) _____ (B) _____

6 Height of Hole Placement: _____

7 Hole Diameter: _____

8 Material Thickness: _____

9 If Beveled, Degree or Angle: _____

10 Round Bottom, Radius: _____

11 Corner, Radius: _____

12 Material Type (Check One):
 Virgin UHMW _____ Nylon _____
 Reprocessed UHMW _____
 Other _____

13 Manufacturer Name (If Known): _____

14 Quantity Needed: _____

15 Customer Part Number: _____

Other Info: _____

Call: 1-800-527-0657 or Visit Us Online at: www.maxilift.com

16400 Midway Rd Dallas, TX 75001 • Ph: (972)735-8855 Fx: (972)735-8896 • info@maxilift.com



Custom Fabrication Of Plastic Parts

From Single Prototypes to Large Production Runs

Custom Fabrication / Made to Order Parts

Maxi-Lift, Inc. manufactures custom made-to-order parts. We carry a huge stock of UHMW sheet, process all of our orders with the latest AutoCAD programs, and utilize the best fabrication equipment to give you the best product for a fair price. We can handle your small custom / prototype orders, or your large production orders.



Key Industries

- Food Processing
- Agriculture
- Forest Products
- Packaging
- Bottling
- Parcel Handling
- Conveying Equipment
- Waste Water / Sewage Treatment

Available Parts

- UHMW Angles
- Chute Liners
- Transfer Plates
- Roller Chain Guides
- Table Top Curves
- Diverter Plates
- Hitch Plates
- Wear Strips
- Guide Rails
- Wear Plates
- Conveyor Parts
- Table Surfaces

- Belt Conveyor Wipers
- Drag Conveyor Flights



Wear Strips

Wear strips are typically used in the following applications: chain guide, flat top chain contact guide and dead plates. Material, size and thickness are custom per your specifications. Typically wear strips are made of UHMW, which is available in White Virgin, Black Reprocessed, Green Reprocessed, Black Anti-Static and Black TL Dry-Slide.

Roller Chain Guides / Custom Curves

Roller chain guides are designed to handle ANSI double pitch chain in packaging and drag chain conveying systems. Also available are custom guides...made just for you, just the way you need. These guides help distribute the load, reduce the friction between surfaces and improve the wear of the chain. UHMW roller chain guides meet FDA/USDA guidelines.

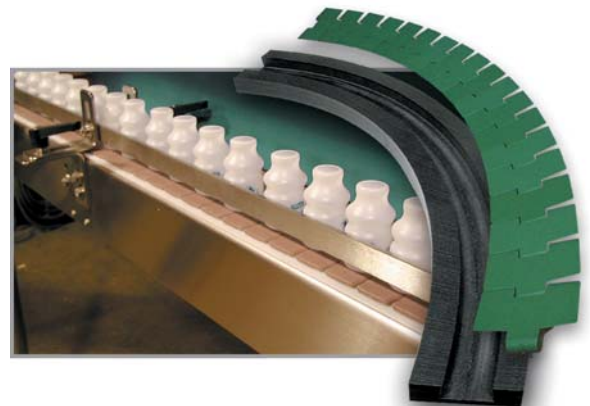

Call: 1-800-527-0657 or Visit Us Online at: www.maxilift.com

16400 Midway Rd Dallas, TX 75001 • Ph: (972)735-8855 Fx: (972)735-8896 • info@maxilift.com